

All Dimensions Are
In mm Unless Stated

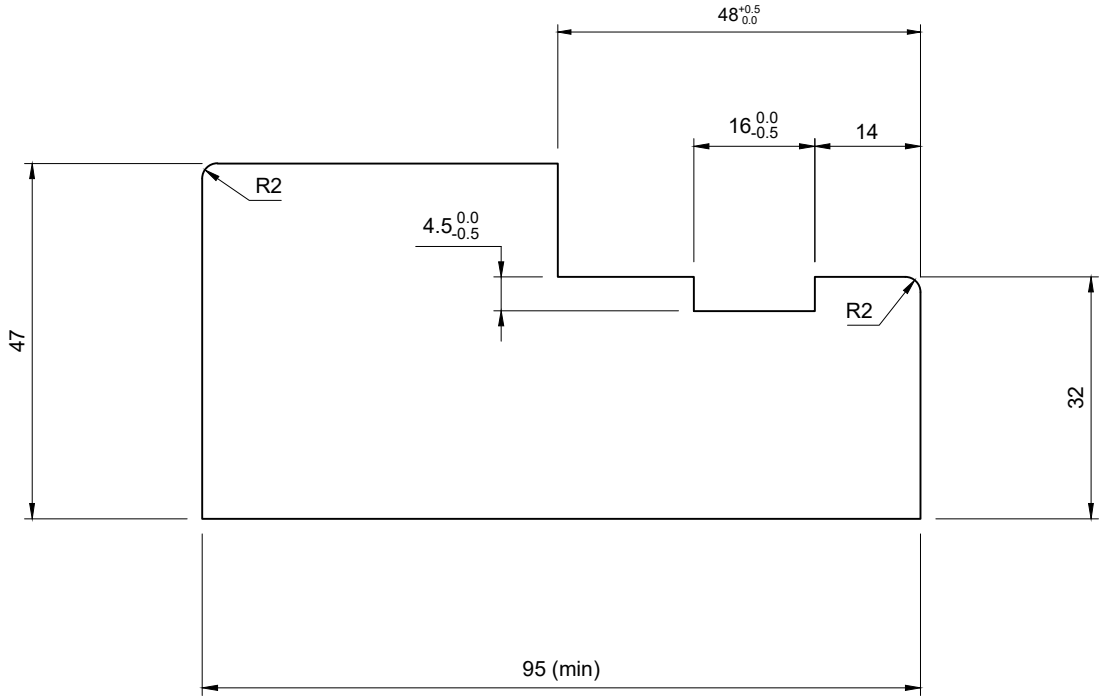

Do Not Scale. If In Doubt Ask!

Description: **Machining Profile 47/32mm PAS24 Single Point Lock - Non Q2F - 45mm Door - FD30**

Drawn By: P. Brash	Approved: Approved	Revision:	Date: 09/05/2023	Drawing No:	 Unit 6, Ranskill Court, Sheffield, S9 5FZ
Size: See Above	Tolerance: +/- 0.5mm		Fire Rating:	DP21492	
Job No:	© Doorpac Ltd		FD30S	Rev 00	